

# For Lease

4450 W. 182nd St., Redondo Beach CA 90278

## Terrific Freestanding Building

### CONTACT:

Lance Levin, PRESIDENT  
[Lance@lancelotcommercial.com](mailto:Lance@lancelotcommercial.com)  
DRE# 01128388

tel. 310.839.3333  
fax. 310.839.3382

### OFFICE LOCATION

8924 LINDBLADE STREET  
CULVER CITY, CA 90232



### Property Information

Available : 6,350 SF  
Lease Price : \$1.45 PSF NNN  
Divisible to : 3,750 and 2,600 SF at \$1.75 SF

### Terrific Freestanding Building

Major boulevard exposure  
Good for many uses including retail / office / flex  
Potential for school / medical / gym

[www.lancelotcommercial.com](http://www.lancelotcommercial.com)

## FEATURES

- Major boulevard exposure
- Fully air conditioned
- Highly-improved interior with hard wood floors
- Clear span space with high ceilings
- 4/1000 parking - gated parking potential
- 1 Block from Galleria South Bay
- 1 Mile to 405 Freeway on/off ramp at Hawthorne
- Centrally located between Redondo Beach and Torrance

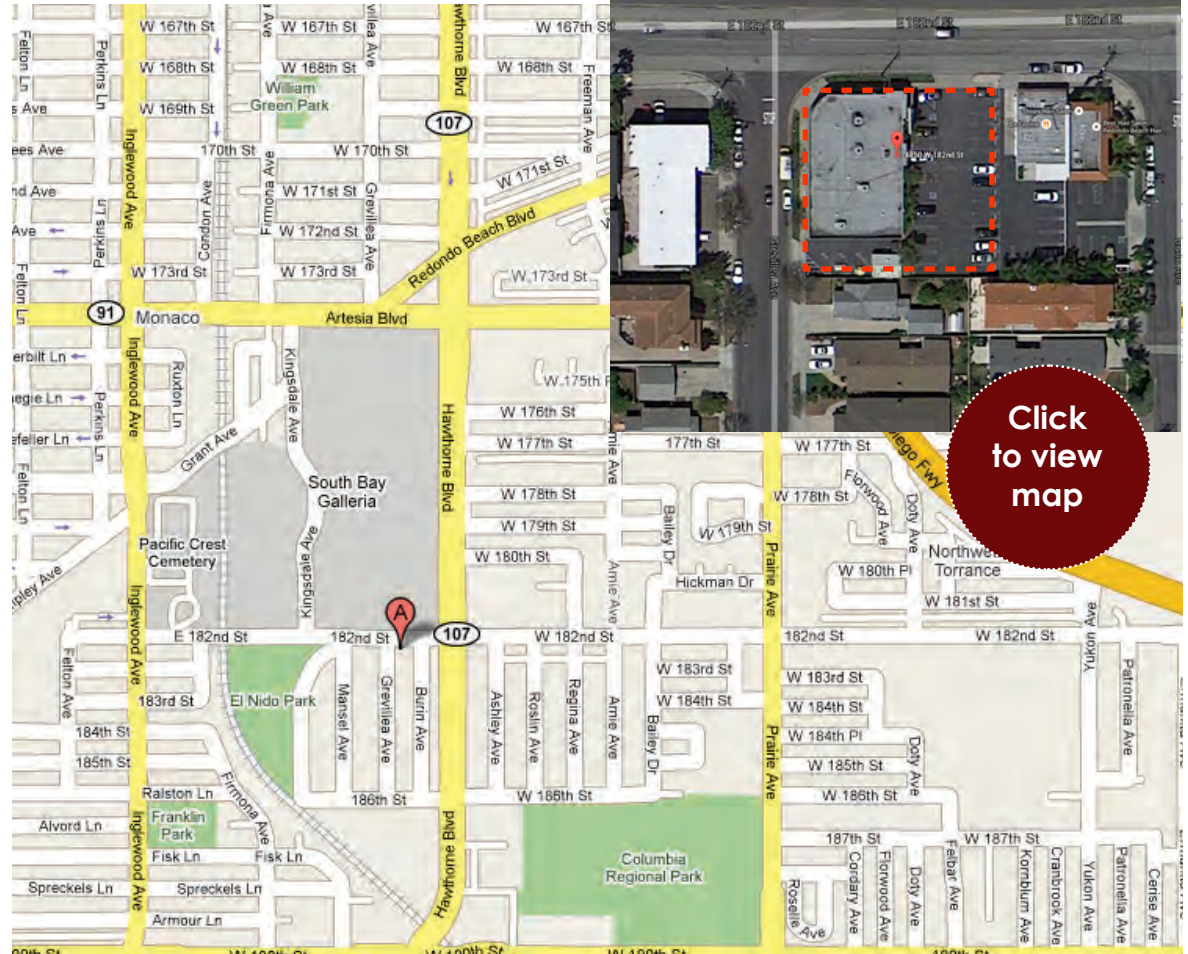

NOTE: All measurements are approximate and while the information furnished comes from reliable sources, we assume no liability.

*"Regardless of the professional broker you choose, it is critical to have a broker who is well versed in all aspects of the market in which you are dealing. You will not find a better brokerage company than Lancelot Commercial with this kind of track record."*

- Lance Levin, President

**LANCELOT**  
COMMERCIAL INDUSTRIAL BROKERAGE

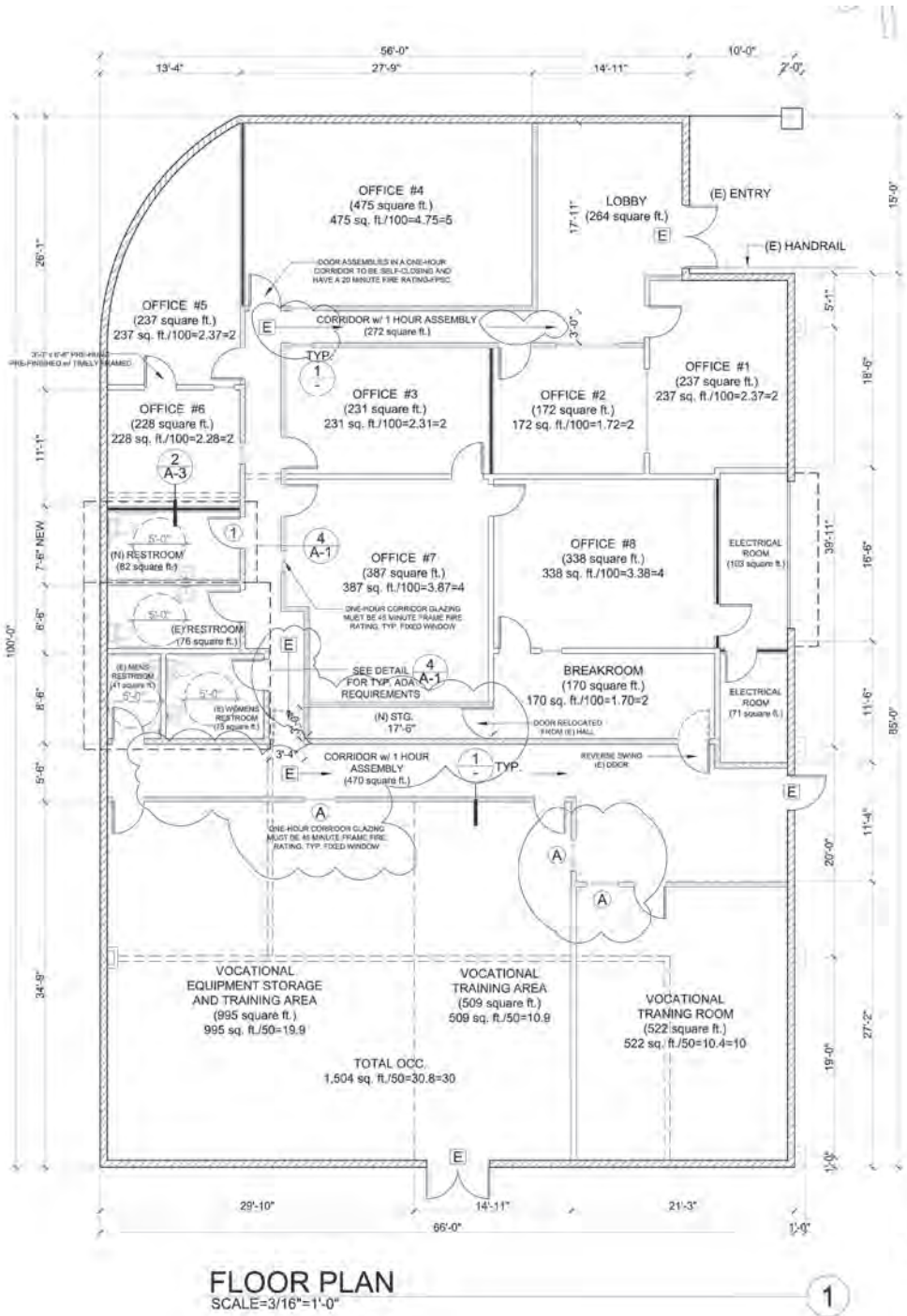

NOTE: All measurements are approximate and while the information furnished comes from reliable sources, we assume no liability.

**LANCELOT**  
COMMERCIAL INDUSTRIAL BROKERAGE